

NO.	DESCRIPTION	REMARKS	UNIT	QUANTITY	UNIT PRICE	TOTAL AMOUNT
1	AREA OF LOT	11728 SQ. M	SQ. M			11728.00
2	AREA OF ROAD	101.58 SQ. M	SQ. M			101.58
3	AREA OF WATER RESERVOIR	11.13 SQ. M	SQ. M			11.13
4	AREA OF OPEN SPACE	120.00 SQ. M	SQ. M			120.00
5	AREA OF ROAD	101.58 SQ. M	SQ. M			101.58
6	AREA OF WATER RESERVOIR	11.13 SQ. M	SQ. M			11.13
7	AREA OF OPEN SPACE	120.00 SQ. M	SQ. M			120.00
8	AREA OF ROAD	101.58 SQ. M	SQ. M			101.58
9	AREA OF WATER RESERVOIR	11.13 SQ. M	SQ. M			11.13
10	AREA OF OPEN SPACE	120.00 SQ. M	SQ. M			120.00

FLOOR AREA	TOTAL AREA	CURTAIN WALL	STAIR CASE	STAIR CASE (C/S)	STAIR CASE (S/S)	STAIR CASE (N/S)	STAIR CASE (E/S)	STAIR CASE (W/S)	STAIR CASE (S/S)	STAIR CASE (N/S)	STAIR CASE (E/S)	STAIR CASE (W/S)
1ST FLOOR	78.39	5.66	0.00	0.00	0.00	0.00	0.00	0.00	0.00	0.00	0.00	
2ND FLOOR	78.39	5.66	0.00	0.00	0.00	0.00	0.00	0.00	0.00	0.00	0.00	
3RD FLOOR	78.39	5.66	0.00	0.00	0.00	0.00	0.00	0.00	0.00	0.00	0.00	
4TH FLOOR	78.39	5.66	0.00	0.00	0.00	0.00	0.00	0.00	0.00	0.00	0.00	
TOTAL	313.56	22.64	0.00	0.00	0.00	0.00	0.00	0.00	0.00	0.00	0.00	

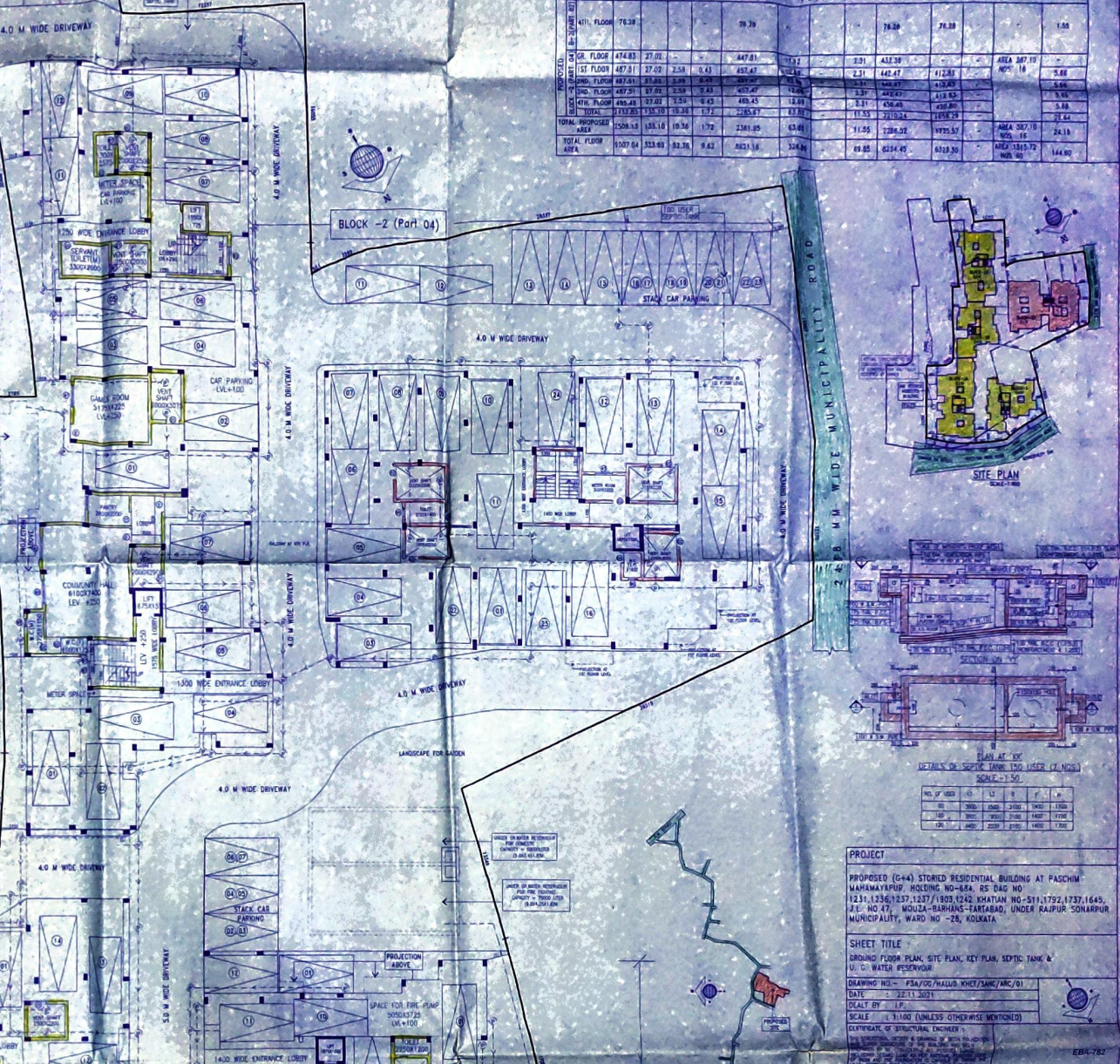
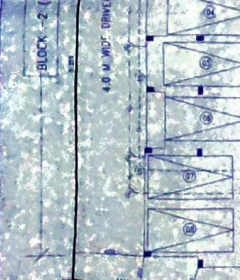
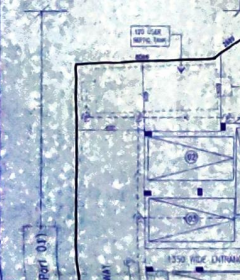
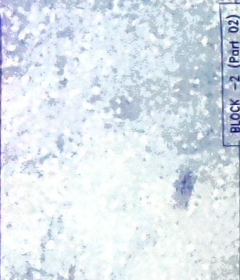
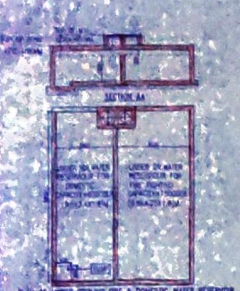

PROJECT

PROPOSED (G+4) STORED RESIDENTIAL BUILDING AT PASCHIM MAHAMAYAPUR HOLDING NO-58A, RS-DAG NO 1231, 1236/1237, 1237/1903, 1242, KHATAN NO-5111792, 1737, 1645, SITE NO 17, KOLLA-SERUNJANA-KATARAKI UNDER RAIPUR-SONARPUR MUNICIPALITY, WARD NO -28, KOLKATA

SHEET TITLE

GROUND FLOOR PLAN, SITE PLAN, KEY PLAN, SEPTIC TANK & H.O. WATER RESERVOIR

DRAWING NO.: P3A/03/HALLO KHET/SANC/ANC/01

DATE: 25.11.2024

SCALE BY: 1:100 (UNLESS OTHERWISE MENTIONED)

SCALE: 1:1000 (UNLESS OTHERWISE MENTIONED)

COURTESY OF: STRUCTURAL ENGINEER

CONTRACTOR: MAHESH KANTA

APPROVED

For: RAIPUR-SONARPUR MUNICIPALITY

MAHESH KANTA

MAHARAJA RAMANANDI

MAHARAJA RAMANANDI

MAHARAJA RAMANANDI

MAHARAJA RAMANANDI